

Section 1. PRODUCT DESCRIPTION

SUPPORT WASHER – TDX-90/TDX-140

Support washers TDX-90/TDX-140 are made from glass fibre-reinforced polyamide. They should be used together with fasteners if mineral wool or mineral wool lamella board is applied as thermal insulation material. Increased surface of the support washer compensates for low strength of wool when drawn through fastener collar. Support washers complement fasteners for fastening of any type of soft mineral wool.



Section 2. EXAMPLE INSTALLATION

- Examples of mineral wool fastening using washers: TDX-90 and TDX-140

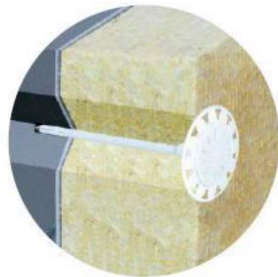

Rys. łącznik z talerzykiem TDX-090 Rys. łącznik z talerzykiem TDX-140

Section 3. TECHNICAL DATA

TECHNICAL PARAMETERS	
Parameter	Value
Plate diameter [mm]	90/140*
Fastener type	WK THERM/WK THERM S/LMX/LFM
Plug diameter [mm]	8/10
Plate material	polyamide
Thermal insulation type	Mineral wool and mineral wool lamella board

*TDX-90/TDX-140

Section 4. REMARKS

1. All previous versions of this Product Data Sheet shall cease to be valid
2. Data given in this Product Data Sheet is in accordance with current knowledge and published in good faith. KLIMAS Sp. z o.o. is not responsible for correctness and quality of the fixing if recommendations regarding method of use and installation are not followed.