

BPA-CEMflex[®] VB

COATED STEEL PLATE WATERSTOP
SOLUTIONS FOR CONCRETE STRUCTURES, FOUNDATIONS AND TUNNELS
INSTALLATION GUIDELINE

EINBAUANLEITUNG FUGENBLECH CEMFLEX VB INSTALLATION GUIDE FOR CEMFLEX VB WATERSTOP PLATE

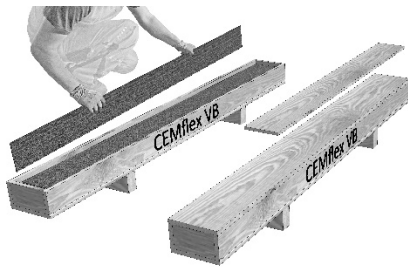

Einzelnes CEMflex VB Vebundblech entnehmen

Remove a CEMflex VB plate from the box

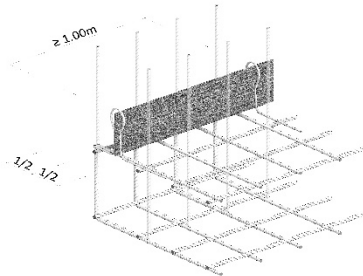

M F -Bügel fixieren

Place the CEMflex VB plate in the middle of the joint, and attach it with an Ω-holder

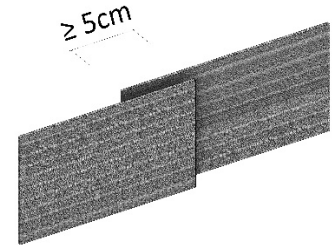

Überlappung 5cm

The overlap must be at least 5cm

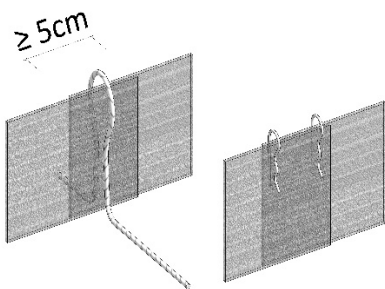

M -Bügel fixieren, alternativ mit CEMflex Clip

Fix the CEMflex VB plate with an Ω-holder or alternatively with CEMflex Clip

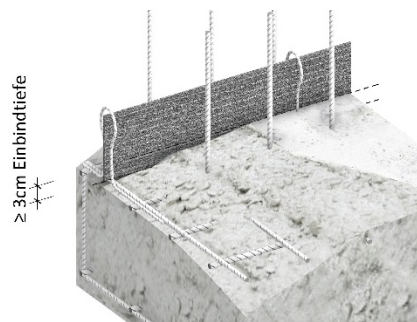

Einbindtiefe min. 3cm

Ensure that the CEMflex VB plate is embedded at least 3cm into the first pour of concrete

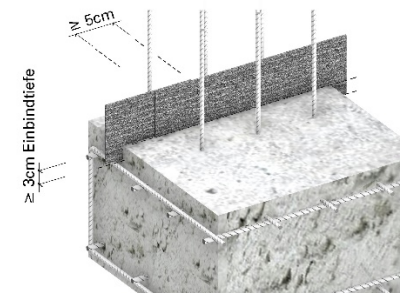

WICHTIG!
Mindest-Überlappung 5cm // Einbautiefe 3cm

VERY IMPORTANT!
Overlap must be at least 5 cm // embedding must be at least 3 cm

Alternativ als Steckblech abweichend von der deutschen WU-Richtlinie

Alternatively, you can push the CEMflex VB into the fresh concrete



CEMflex in den Frischen Beton stecken (min 3cm)

Insert CEMflex into the fresh concrete (min 3cm)

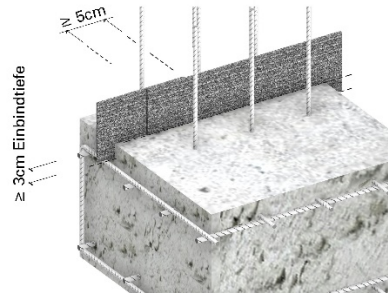

Überlappung mit Steckblech

Overlap must be at least 5 cm // embedding must be at least 3 cm

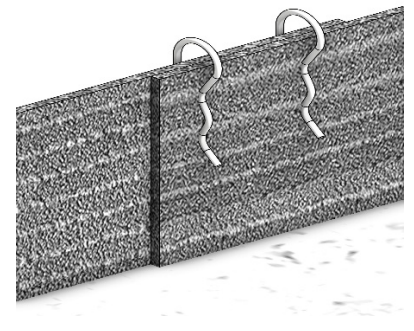

Überlappungen mit CEMflex Clip fixieren

clip the CEMflex VB overlap together with CEMflex clips

Eckausbildung / *CEMflex corner forms*

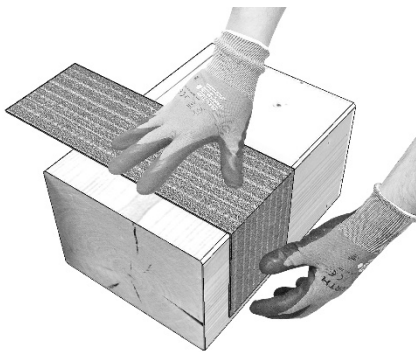

Blech in die gewünschte Form biegen

Bend the CEMflex VB plate as required

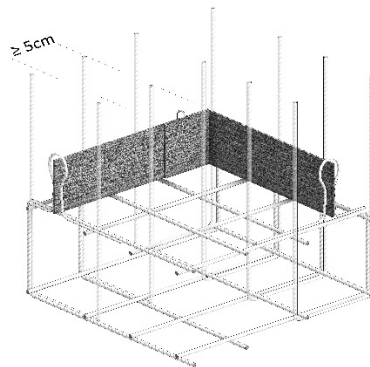

M F

Place the CEMflex VB plate in the middle of the joint

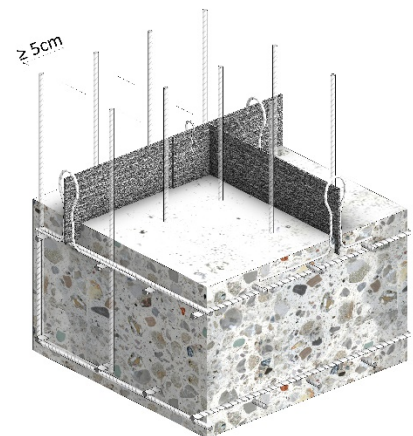

-Bügel fixieren

T-Stosse bauseits abwinkeln

If a T joint is needed, bend CEMflex as needed with a minimum overlap of 5 cm

Anschluss Fugenband / *Connecting CEMflex to a PVC Waterstop*

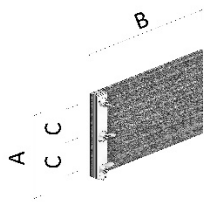

CEMflex Klemmplatte
CEMflex clamping plate

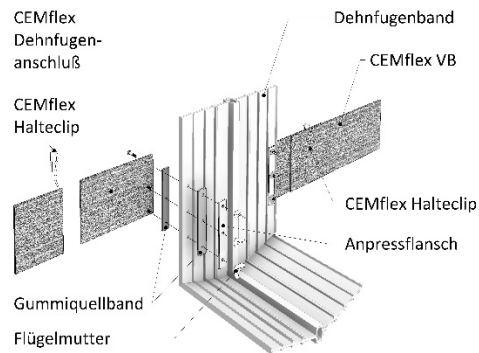

Flügelmuttern öffnen und auseinander bauen
Open the thumbscrews and remove plates

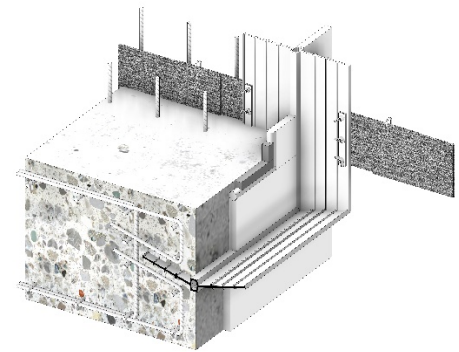

Fugenband dazwischen klemmen und schließen
Put the PVC water stop between the steel plates and swell tape and fasten the thumbscrews again

Befestigungsmaterialien / Accessories

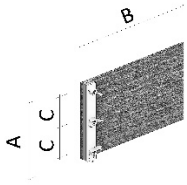
| | | | |
|--|---|--|---------------|
| <p>BPA- CEMflex Omega Bügel <i>BPA- CEMflex Omega holder</i></p> |  | <p>Mit dem Omega Bügel wird das Verbundblech BPA-CEMflex an der Bewehrung fixiert <i>CEMflex Omega holder to attach the CEMflex to the reinforcement</i></p> | <p>13-807</p> |
| <p>BPA-CEMflex Clip <i>BPA-CEMflex Clip</i></p> |  | <p>BPA-CEMflex-Clips für die Fixierung von Überlappungsstößen <i>BPA- CEMflex clips for the overlaps</i></p> | <p>13-802</p> |
| <p>BPA-CEMflex Klemmplatte <i>BPA-CEMflex clamping plate</i></p> |  | <p>Verbindung zwischen dem CEMflex und dem Fugenband <i>Connection between CEMflex and the PVC Water stop</i></p> | <p>13-801</p> |

FURTHER PRODUCTS

AND THEIR FIELDS OF APPLICATION MADE BY BPA

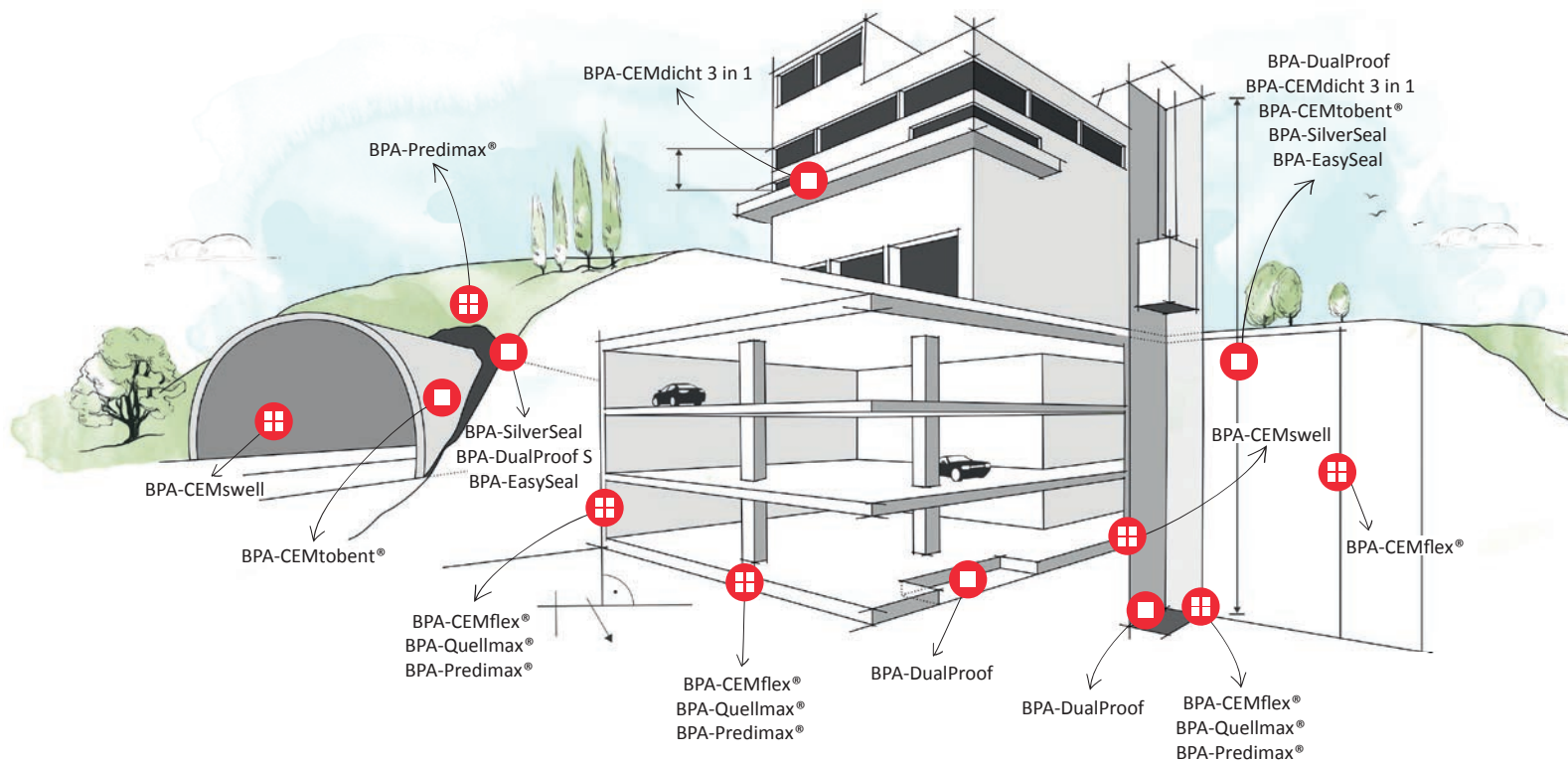

 Joint sealing

 External surface waterproofing



BPA
WATERPROOFING SYSTEMS

BPA GmbH TEL +49 (0)7032 89 399 - 0
Behringstraße 12 FAX +49 (0)7032 89 399 - 29
D-71083 Herrenberg MAIL info@BPA-waterproofing.com

www.BPA-waterproofing.com

Presented by:

BPA Distribution Partner